

Vertical Briquetting Machine



The VERTICAL briquetting machine is a compact machine suitable for all the production.

The VERTICAL machine is suitable for more solutions, can be positioned under an Exhaust filter or under a silo of material collection. The container can be modified for the customer necessity.

The construction and function principle of this briquetting machine is the same of all the standard briquetting machine.

The loading system of the material is developed with an Archimedean Screw.



Hydraulic briquette press

Model	A	B	C	Container Basement	Motor	Briquette Dimensions	Weight	Output
VERTICAL	mm	mm	mm	mm	Kw	Ø mm	Kg	Kg/h
E55	1850	1230	1500	1000x1000	5,5	55	770	15/60
E60 Super	2000	1230	1500	1000x1000	7,5	60	870	40/100
E70 Eco	2000	1230	1500	1000x1000	7,5	70	870	50/120

Output depends of the type of material.

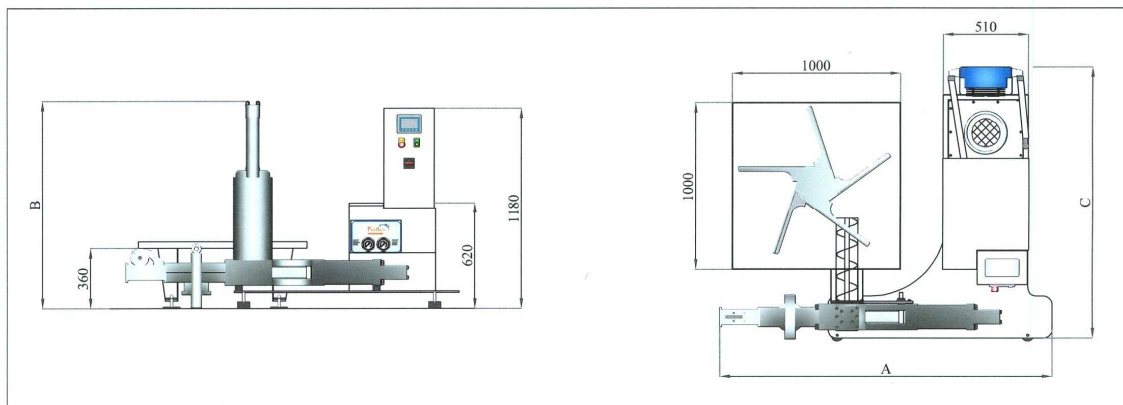

VERTICAL Presse is supplied of:

- Sensitive probe.
- Cycle end device.
- Tapping head.
- Pre-heating System.
- Probe for the level of the oil.
- Temperature Oil Probe.
- Automatic regulation of loading material.
- Double manometer for vice pressure control.
- Air Oil Cooling System.
- Service keys.
- Use and maintenance manual.

TECNICAL DETAILS:

- Hydraulic Machine.
- Motor Kw 5,5 – Kw 7,5.
- N° 7 cycles/min.
- N° 3 cylinders.
- N° 1 vice without spacers.
- Briquette's length max 50 mm.
- Power panel with Siemens Touch PLC.
- Voltage 400V – 50 Hz.
- Container basement complete with a mixer and Archimedean Screw for the material loading. Standard dimensions 1000 mm x 1000 mm.

The machines satisfies CE standards.

N.B.: The values indicated are purely indicative and may vary depending on the kind of material. The constructor reserves the right to make changes at any moment.

PRODECO S.R.L

Via Francesco Lana, 39 - 25020 FLERO (BS) ITALIA - Tel. +39 030 3583385 r.a/ Fax +39 030 6346239
www.prodeco-srl.com - E-mail: info@prodeco-srl.com